

FILED
GREENVILLE CO. S. C.

MAR 9 3 14 PM '79
SECOND FLOOR

LEWIS VILLAGE HORIZONTAL PROPERTY REGIME

GREENVILLE COUNTY
GREENVILLE, SOUTH CAROLINA

Scale 1" = 40' February, 1979

DALTON & NEVES CO., ENGINEERS

121 MANLY STREET

GREENVILLE, S. C.

The undersigned certifies that the boundary for the property was drawn from an actual survey dated February, 1979 made by me and that the courses and distances are true and correct, that the building and improvements located thereon are accurately located, that the building and improvements do not encroach or project over the boundary lines, except encroachment of garage as shown hereon:

R. W. [Signature]
S. C. Reg. No. 916

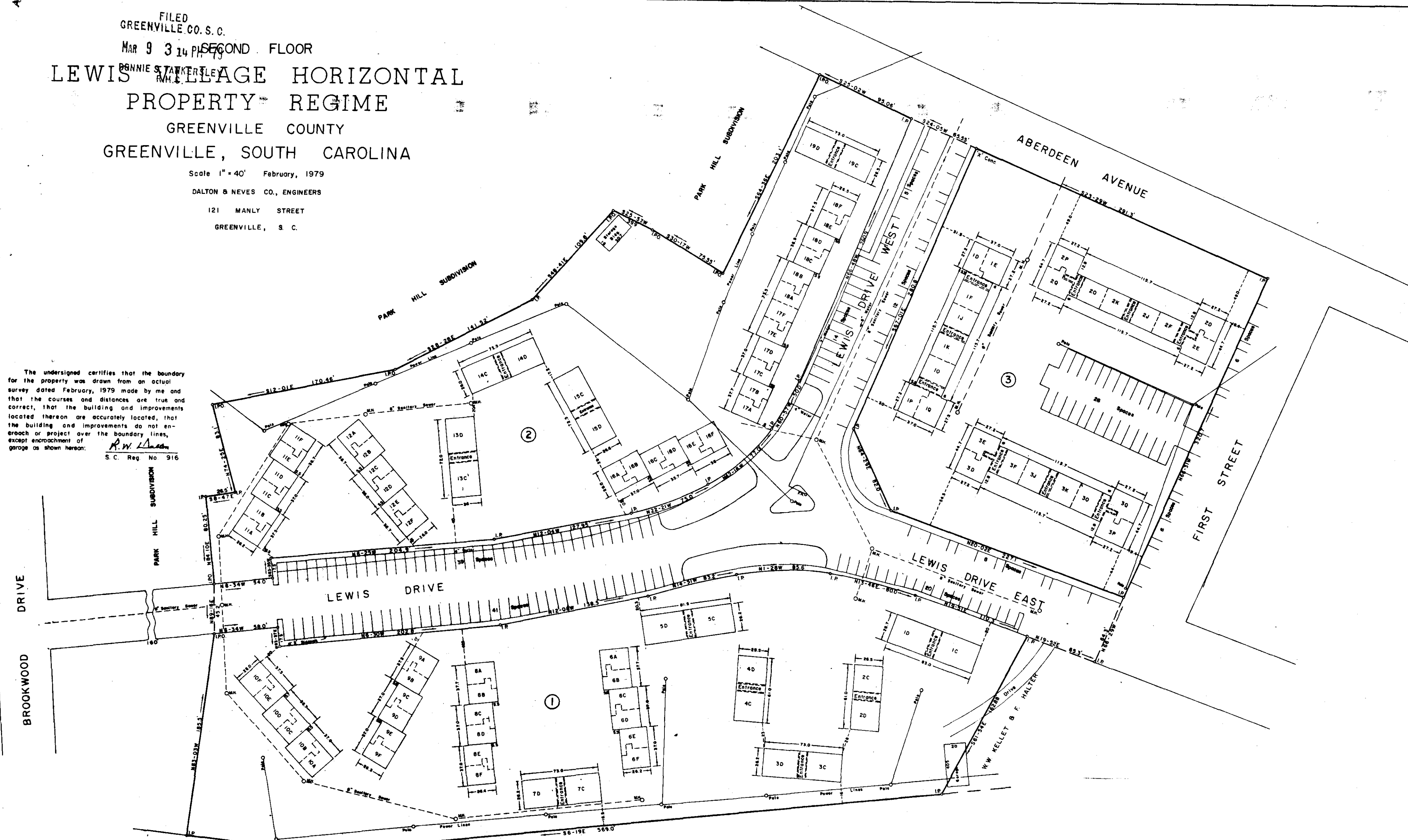

BROOKWOOD DRIVE

MELVILLE AVENUE

THIS PLAT IS NOT A SUBDIVISION
AS DEFINED BY THE GREENVILLE
COUNTY SUBDIVISION REGULATIONS.
3.9.79 *Ray J. Carter*
Chairman, Director of
Planning,
Greenville County Planning Commission

LEGEND

1. This plat plan shows location of Buildings 1 through 19 and 1 through 3 (Plaza) containing a total of 142 units.
2. The additional sheets of this Exhibit B show typical floor plans for the units, their location in each building, and typical front building elevations.
3. Each unit consists of the space bounded by the undercoated and/or unfinished surfaces of the perimeter walls, floors and ceilings.
4. All interior angles in unit are 90° unless otherwise noted.
5. Common Elements: - - - - -
6. General Common Area: =====



AREA ① = 3.25 ACRES
 AREA ② = 2.78 ACRES
 AREA ③ = 2.15 ACRES
 TOTAL = 8.18 ACRES

GCTO ---3 MR.9 79 061

3.00CI

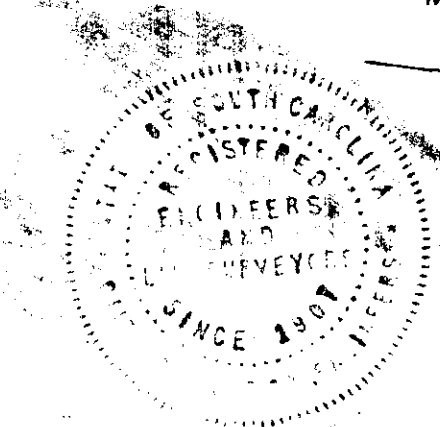

25883
6-V-57

100-011001